

Ballinagree

This farm is located in Ballinagree, Macroom, Co. Cork. It has a heavy clay soil with poor permeability and quite stony. It is at an elevation of 150 metres at lowest point to 310 metres at highest and has very steep hills.

Teagasc Advisor: Ciara O'Shea +353 (0)26 43511

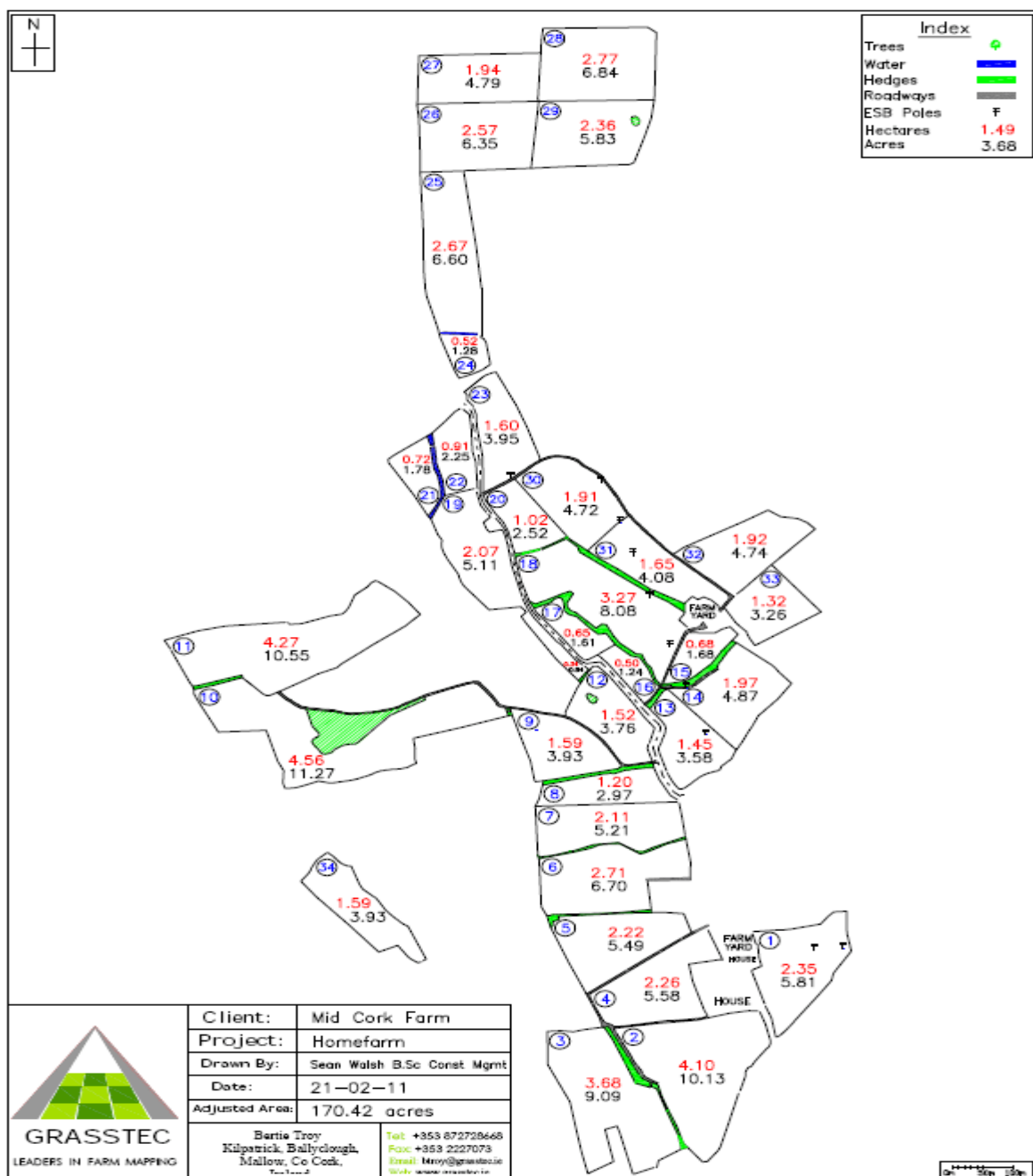

Table 1. Farm Performance

Year	Herd Size	Stocking Rate	Area MP	Herd EBI	Fertility	6 week
		MP	Ha	Total		Calv %
2011	83	1.58	52.5	88	47	58
2012	82	1.56	52.6	106	67	60
2013	83	1.58	52.5	123	72	74
2014	81	1.54	52.6	130	83	79
2015	79	1.79	44.1	151	88	60
2016	108	2.05	52.7	86	41	72
2017	118	2.95	40	94	45	75
2018	130	3.25	40	121	51	77
2019	120	3	40	137	54	79

Herd size has increased from 83 in 2011 to 120 in 2019 with a corresponding increase in milking platform stocking rate.

Table 2. Dairy Outputs

Year	Milk Solids/ha	Gross Output		Total Costs		Net Margin	
		€/Ha	c/litre	€/Ha	c/litre	€/Ha	c/litre
2011	708	3212	36.3	1560	17.6	1652	18.7
2012	687	3218	38.6	1852	22.2	1366	16.4
2013	727	3445	39	1978	22.4	1467	16.6
2014	726	3480	39.3	1784	20.1	1696	19.2
2015	905	3116	31.6	1827	18.5	1289	13.1
2016	998	3158	28.8	1519	14.6	1640	14.2
2017	1451	4992	38.56	1870	14.65	3051	23.91
2018	1713	5278	36.36	2731	18.82	2546	17.54
2019	1605	4552	34.16	2361	17.72	2191	16.45

Table 2 shows a steady growth on milk solids.

Table 3. Grass production Tonnes Dry Matter/Ha

Year	Start Grazing	End Grazing	Total Grown
2013	29 th April	4 th Nov	8.7
2014	26 th Mar	7 th Nov	9.2
2015	10 th Apr	11 th Nov	10.1
2016	25 th Feb	20 th Nov	11.9
2017	25th Feb	10th Nov	9.7
2018	27th Feb	21st Nov	12
2019	16th Feb	5th Nov	12.8

There has been a considerable investment in correcting soil fertility which is reflected in the steady increase in grass production.