

Castleisland Farm, Kerry

This farm is located near Castleisland, Co. Kerry. It has a heavy clay soil with good depth but poor permeability. There are 100 cows milking with plans through the long term lease of similar land adjoining the farm to expand to 110 cows.

Teagasc Advisor: Denis Brassil +353 (0)64 6621714

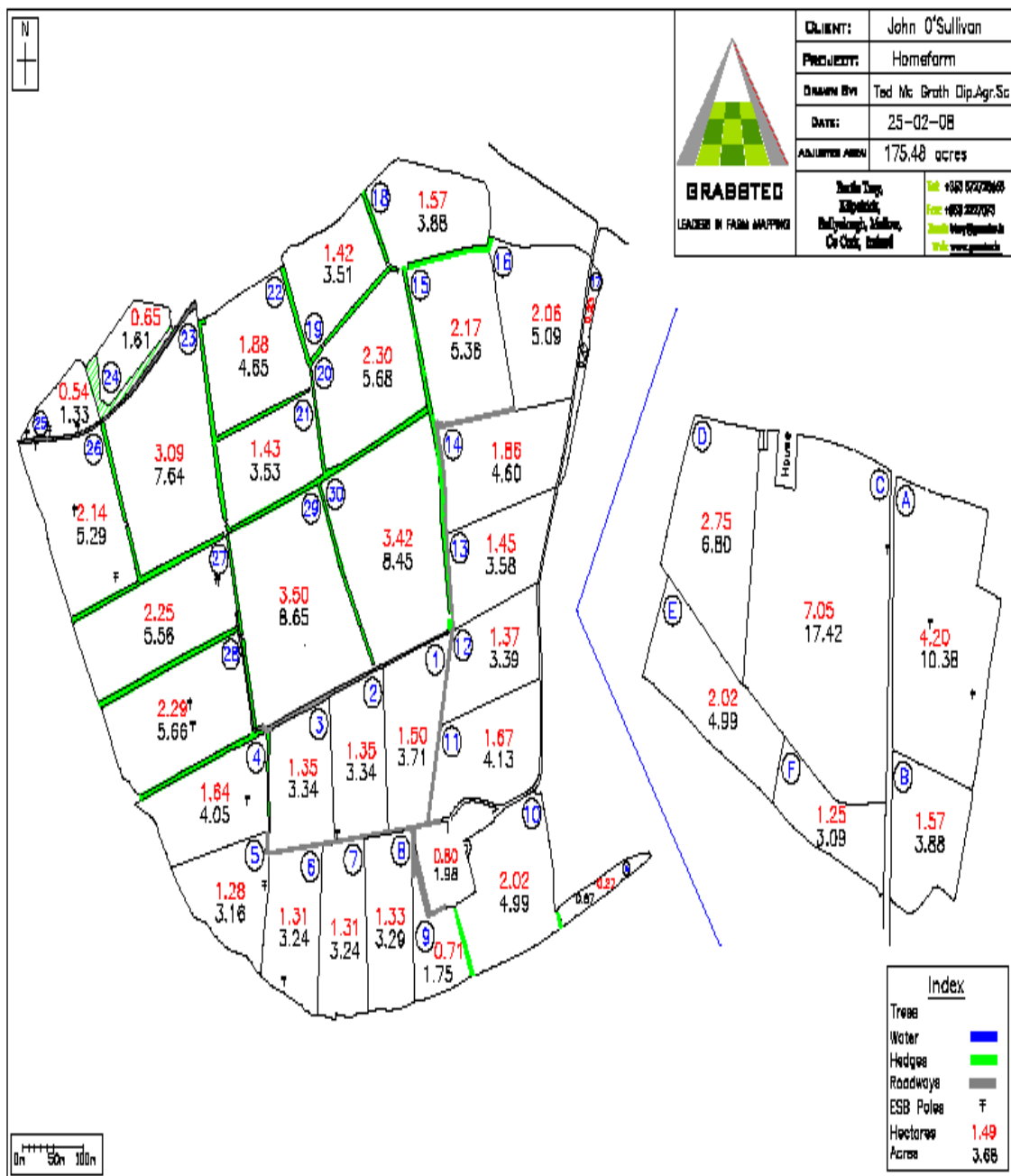

Table 1. Farm Performance

Year	Herd Size	Stock rate	Area MP	Herd	EBI	6 week
		MP	Ha	Total	Fertility	Calv %
2011	88	2.28	38.6	62	28	85
2012	92	2.38	38.7	82	47	66
2013	94	2.44	38.5	112	59	69
2014	94	2.44	38.5	128	70	59
2015	100	2.49	38.6	135	75	62
2016	104	2.69	38.7	69	32	80
2017	111	2.88	38.6	74	36	82
2018	106	2.79	38	102	47	83
2019	106	2.79	38	115	51	83

Herd size has grown from 88 in 2011 to 106 in 2019 which is reflected in stocking rate increase from 2.28 cows per hectare in 2011 to 2.79 cows per hectare in 2019.

Table 2. Dairy Outputs

Year	Milk Solids/ha	Gross Output	Gross Output	Total costs	Total costs	Net margin	Net margin
	Kg	€/Ha	c/litre	€/Ha	c/litre	€/Ha	c/litre
2011	1019	3357	32.4	1972	19	1385	13.3
2012	1023	3156	32.4	2549	26.2	605	6.2
2013	1111	3932	36.3	2565	23.7	1367	12.6
2014	1106	3940	36.4	2346	21.7	1594	14.7
2015	1209	3179	29.7	2219	20.7	960	9
2016	1178	2829	26.4	2074	20.5	755	5.9
2017	1375	4446	35.81	2411	19.42	2035	16.39
2018	1458	4467	36.35	2947	23.98	1520	12.37
2019	1477	4415	36.14	2441	19.98	1974	16.16

Milk solids production per hectare has grown from 1019 kgs in 2011 to 1477kgs in 2016. The effects of the very wet summer of 2012 is starkly illustrated with increased costs bringing down net margin per hectare from €1385 in 2011 to €605 in 2012.

Table 3. Grass production Tonnes Dry Matter/Ha

Year	Start Grazing	End Grazing	Total Grown
2011			11.5
2012			9.9
2013	26 th Feb	12 th Nov	13.1
2014	16 th Apr	7 th Nov	15.5
2015	16 th Mar	18 th Nov	13.8
2016	14 th Mar	13 th Nov	11.4
2017	28th Mar	2nd Dec	14
2018	06th Mar	19th Nov	9.8
2019	23rd Feb	24th Nov	11.3

